

**Bystronic UK Limited**  
6 Wayside Business Park  
Wilsons Lane  
CV6 6NY Coventry  
UK

T +44 2476 585100  
F +44 2476 585101  
sales.uk@bystronic.com  
www.bystronic.co.uk

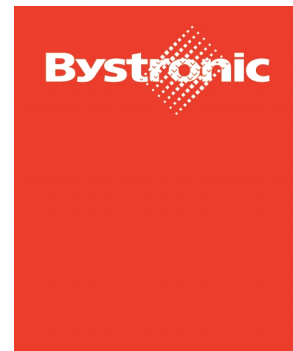

Mr Dave Newbury  
Kelvion Ltd  
Davis Way 20  
Newgate Lane  
Fareham Hampshire  
PO14 1AR

**Best choice.**

30th November 2016

## **Technical Specifications**

**No. QUO-35616**

### **Xact Smart 225/4100**

Economical machine for good bending results



**Intuitive operation**

All new Xact – the quick entry into world class bending ensures intuitive operation by the easy programming with the ByVision Bending from Bystronic which helps to simplify the processes and ensures best part quality.

**Reduced investment risk**

Excellent price performance ratio reduce the financial risk e.g. With the help of the hydraulic crowning from Bystronic which ensures constant bending quality.

**Optimized process chain**

The new Xact can be connected with the time saving BySoft 7 which is increasing the efficiency and helps to save costs.

## Technical data - Standard machine

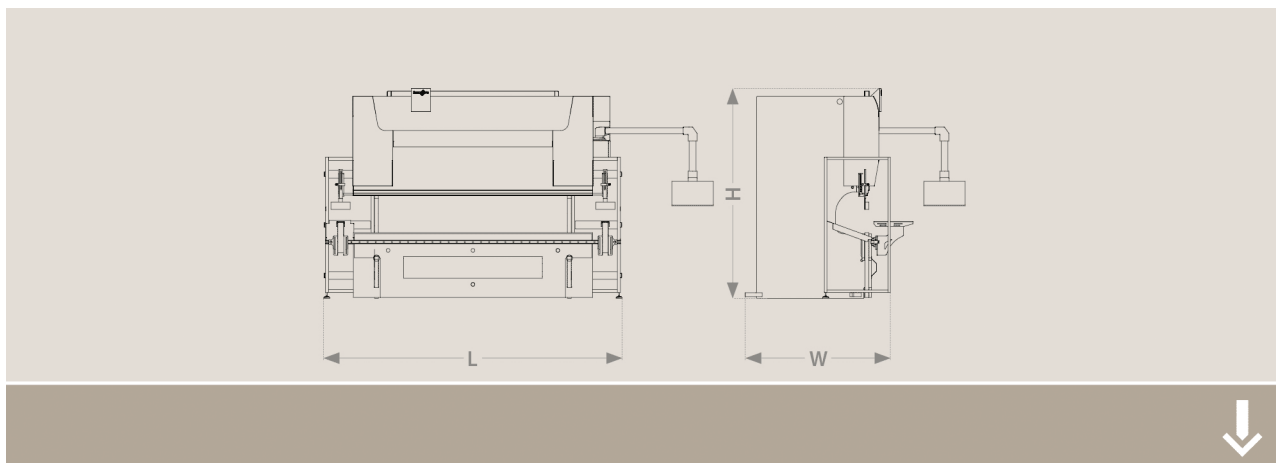

Tonnage	2250	kN
Bending length	4100	mm
Standard stroke [S]	200	mm
Open height [D]	480	mm
Distance between side frames	3420	mm
Throat [T]	400	mm
Table Width	60	mm
Max. back gauge range X-axis	800	mm
X-axis travel	600	mm
X-axis speed	400	mm/s
X-axis accuracy	0,05	mm
R-axis travel	150	mm
R-axis speed	100	mm/s
R-axis accuracy	0,05	mm
Z-axis travel	2880	mm
Z-axis speed	400	mm/s
Y-approach speed (up to)	140	mm/s
Y-working speed (up to)	10	mm/s
Accuracy Y-axis	0,01	mm
Oil capacity	350	l
Electric supply	15	KW
Weight	15	t
Length, approx. [L]	4950	mm
Width, approx. [W]	1510	mm
Height, approx. [H]	2890	mm

## 1 Basic machine

### 1.1 Xact Smart 225/4100



### 1.2 ByVision Bending control with 22 Inch Full HD display and touch technology



Life is fast, 3D, Full HD and touchable - such as bending with the new ByVision Bending from Bystronic.

We have taken the experience which millions of people love from touch devices. In addition we have taken over many years global standard setting Bystronic bending know how such as the calculation of the technology and generation of the process data by the push of a button. Finally we packed this into the ByVision Bending control technology. That's why it is amazingly easy to operate.

With 22inch the ByVision control has nearly double the size of most conventional controls and gives best user ergonomics without compromises.

One of the biggest break through is that it allows to design a new bending application with a few tabs in the profile editor or import an offline prepared application made on the time saving BySoft7.

The ByVision Bending is made in IP54 quality and equipped with a network interface as well as plenty USB slots. For operators who would like to have more than the average information it is possible to add an additional monitor.

### 1.3 ByVision controlled hydraulic crowning



The compensation of the deflection of the upper and the lower beam takes place by a hydraulic crowning system.

The ByVision controlled crowning ensures precise angles and straightness of the parts.

## 1 Basic machine

### 1.4 Safety System Fast Bend S

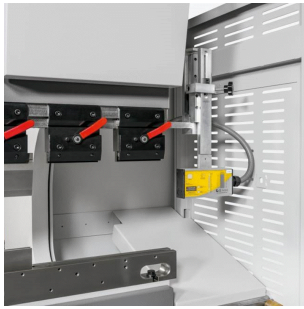

Fast Bend S is the easy and fast adjustable safety system which combines good productivity and protection of the operator.

The laser protection on the operating side is adjustable in height and interrupts the bending process if the laser beam is broken. This ensures that work accidents are effectively prevented.

### 1.5 2 manual adjustable front supports, length 400mm

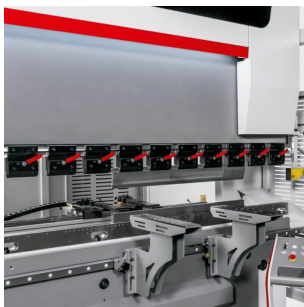

The front support arms can be moved manually in the Y- and Z-direction.

The brackets are equipped with ball heads for easy moving the components.

Capacity: 100kg per unit.

### 1.6 Table T5/90

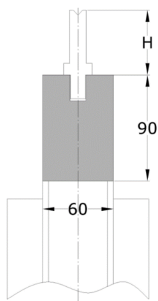

The machine is equipped with a slim T21 type table suitable for Bystronic single vee lower die's.

The table T21 is 90 mm high and 60 mm wide.

### 1.7 Upper tool clamping type "Euro-B" mechanical (fast clamping plates)



Fast Euro-B clamping plates (3100 mm bending length 15 adapter, 4000 mm bending length 19 adapter).

The fast clamping plates are 100mm in height and allow vertical tool insertion.

The max. capacity of tools/clamping is 1000kN/m.

## **1 Basic machine**

### **1.8 2-axis back gauge system**

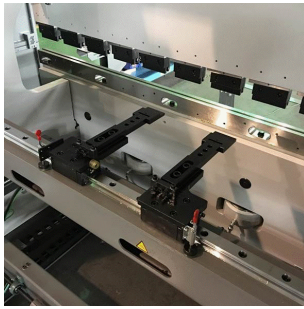

The press brake is provided with a back gauge system with automatic positioning in the X and R axis via the DNC control.

Both fingers can be manually adjusted laterally in the Z-direction.

Finger height: 20 mm (10/10)

### **1.9 Electrically interlocked side fences**



The electrical interlocked side fences prevent injuries of the operating staff. Catching sideways into the working space is prevented.

### **1.10 Rear protection devices / sliding door incl. interlocking switch**



The rear protection device is equipped with a sliding door on one side and electrically interlocked.

### **1.11 Linear guide on lower beam**

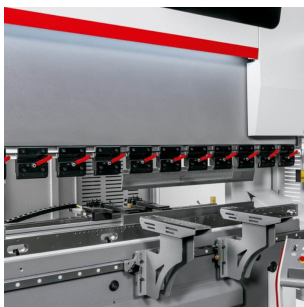

A linear guide rail is fitted on to the lower beam to facilitate quick movement of the front support arms sideways along the machine (Z-axis). They can also be adjusted vertically (Y-axis).

## 1 Basic machine

### 1.12 Control console with foot switch



Ensuring user ergonomics the control console with foot switch is made in a very light design.

### 1.13 Ambient air temperature 7°C up to 35°C

### 1.14 Voltage: 400/480 V, 50/60 cycles, 3 Ph (other parameters available on request)

## 2 Other variations

### 2.1 Hydraulic Oil

First fill of hydraulic oils is included

## 3 At the rear of the machine

### 3.1 4-axis back gauge X, R, Z1, Z2



Compared to the standard back gauge this is extended by two additional axes Z1, Z2 controlled by the ByVision.

Z-axis speed: 400 mm/s

Finger height: 20 mm (10/10)

All other technical data are similar to the standard 2-axis back gauge system.

## 4 Tools

## 4 Tools

### 4.1 Bottom Tool V12/30° L=1030 (64201.0012.3009)



### 4.2 Bottom Tool V12/30° L=1000 sect.FSC (64201.0012.0002)



### 4.3 Upper Tool 1014/88° R=0,8 L=835 EURO-B (65088.1014.4005)

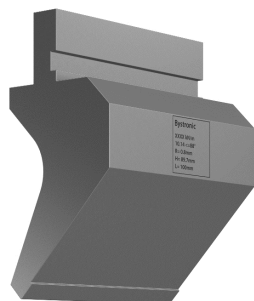

### 4.4 Upper Tool 1014/88° R0,8 L=835 EURO-B sect (65088.1014.3003)

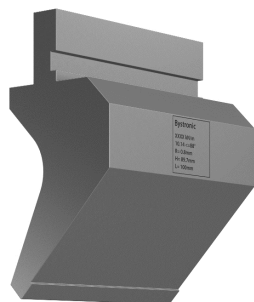



## 4 Tools

### 4.5 Upper Tool 1012/35° R=0,8 L=835 EURO-B (65035.1012.4003)



### 4.6 Upper Tool 1012/35° R0,8 L=835 EURO-B sect (65035.1012.3003)

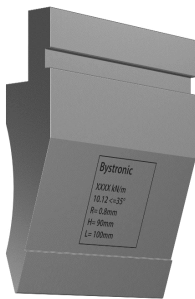

## 5 Installation

### 5.1 Delivery and Installation

Delivery to your works, including offloading, positioning and bolting down

## 6 Additional agreements

### 6.1 Part Exchange of Edwards Pearson PR10 150/4000 (1997) complete with RFA Upper Tool Clamping and full set of used Upper and Lower Pressbrake Tooling

Bystronic will purchase Kelvion Ltd's existing Edwards Pearson PR10 150/4000 in part exchange for the sum shown (Excluding VAT). This price is dependent on the machine being maintained in good condition and in full working order at Kelvion Ltd's expense until removal.

## 7 Training

## **7 Training**

### **7.1 Training for Xact/Xcel pressbrakes**

2 day training course on site for maximum 4 people. This course covers machine operation and control. All trainees must be computer literate with a knowledge of Windows-based systems